

|                           |                           |   |
|---------------------------|---------------------------|---|
| 10462000                  | <b>DATA SHEET</b>         |  |
| Valid from:<br>18.06.2024 | <b>EPIC® H-A 16 AG-LB</b> |   |

Description

- These connectors are attractive because of their compact housing.
- Small and compact for applications with high number of contacts



General characteristics

|                              |  |
|------------------------------|--|
| Series                       | H-A 16                                   |
| Version                      | Panel mount base                         |
| Locking                      | single lever                             |
| Protection (DIN EN 60529)    | IP 65 (latched)                          |
| Protection (NEMA 250, UL50E) | 4, 12 (latched)                          |
| Temperature range            | -40°C to +100°C, short-term up to +125°C |

Materials and surfaces

|         |                                      |
|---------|--------------------------------------|
| Housing | Aluminium alloy, powder-coated, grey |
| Lever   | Steel, zinc-plated                   |
| Gasket  | NBR                                  |

Approvals

|                            |        |
|----------------------------|--------|
| VDE-Approval, VDE-REG.-Nr. | B437   |
| UL File Number             | E75770 |

Standards

|                 |                                   |
|-----------------|-----------------------------------|
| Safety Standard | IEC 61984, UL1977, CSA 22.2 182.3 |
|-----------------|-----------------------------------|

|   |                                       |             |
|---|---------------------------------------|-------------|
| Creator: MANA2/PDP<br>Released: IVSE1/PDP | Document: DB10462000EN<br>Version: 02 | Page 1 of 2 |
|---|---------------------------------------|-------------|

|                           |                    |   |
|---------------------------|--------------------|---|
| 10462000                  | <b>DATA SHEET</b>  |  |
| Valid from:<br>18.06.2024 | EPIC® H-A 16 AG-LB |   |

## Drawings

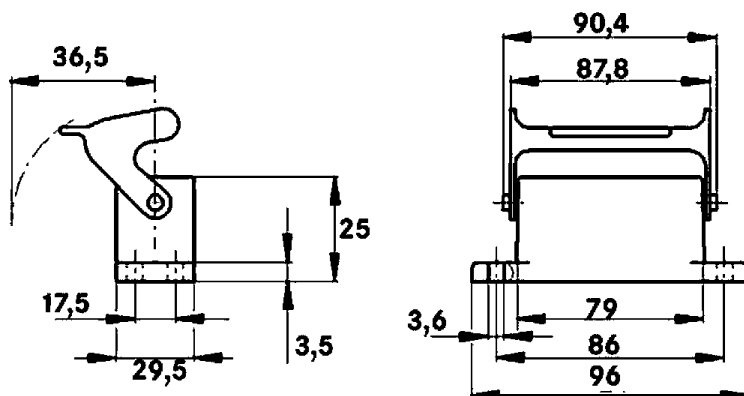

Industrial machinery and plant engineering



Mechanical resistance



Robust



Waterproof

## Info

Compact, robust metal housings size H-A 16

## Application range

Machine and equipment manufacturing  
Control engineering  
Electronic laboratory

## Remark

Photographs are not to scale and do not represent detailed images of the respective products.

|   |                                       |             |
|---|---------------------------------------|-------------|
| Creator: MANA2/PDP<br>Released: IVSE1/PDP | Document: DB10462000EN<br>Version: 02 | Page 2 of 2 |
|---|---------------------------------------|-------------|